

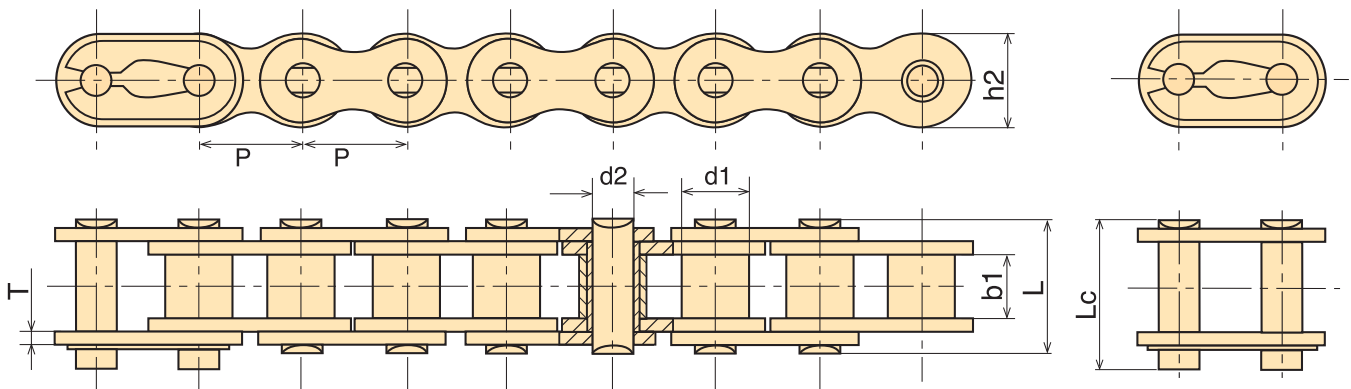

	PART NUMBER: WN-RC40 FEATURES: #40 Chain, 10ft Roll, 2.02kg		PART NUMBER: WN-CL40IMP FEATURES: Connector Link for #40 Chain, Pack of 4		PART NUMBER: WN-RC100HIMP FEATURES: #100H Chain, 10ft Roll, Heavy Duty, 14.06kg
	PART NUMBER: WN-RC50IMP FEATURES: #50 Chain, 10ft Roll, 3.31kg		PART NUMBER: WN-RC50X50IMP FEATURES: #50 Chain, 50ft Roll, 16.33kg		PART NUMBER: WN-CL50IMP FEATURES: Connector Link for #50 Chain, Pack of 4
	PART NUMBER: WN-RC50HIMP FEATURES: #50H Chain, 10ft Roll, Heavy Duty, 3.56kg		PART NUMBER: WN-RC50HX50IMP FEATURES: #50H Chain, 50ft Roll, Heavy Duty, 18.14kg		PART NUMBER: WN-CL50HIMP FEATURES: Connector Link for #50H Heavy Duty Chain, Pack of 4
	PART NUMBER: WN-RC60IMP FEATURES: #60 Chain, 10ft Roll, 4.74kg		PART NUMBER: WN-RC60X50IMP FEATURES: #60 Chain, 50ft Roll, 24.04kg		PART NUMBER: WN-CL60IMP FEATURES: Connector Link for #60 Chain, Pack of 4
	PART NUMBER: WN-RC60HIMP FEATURES: #60H Chain, 10ft Roll, Heavy Duty, 5.66kg		PART NUMBER: WN-RC60HX50IMP FEATURES: #60H Chain, 50ft Roll, Heavy Duty, 28.58kg		PART NUMBER: WN-CL60HIMP FEATURES: Connector Link for #60H Heavy Duty Chain, Pack of 4
	PART NUMBER: WN-RC80HIMP FEATURES: #80H Chain, 10ft Roll, Heavy Duty, 9.35kg		PART NUMBER: WN-CL80HIMP FEATURES: Connector Link for #80H Heavy Duty Chain, Pack of 4		PART NUMBER: WN-CL100HIMP FEATURES: Connector Link for #100H Heavy Duty Chain, Pack of 1



Part Number	DIN/ISO Chain No.	ANSI Chain No.	Pitch	Roller Diameter	Width Between Inner Plates	Pin Diameter	Pin Length		Inner Plate Depth	Plate Thickness	Ultimate Tensile Strength	Average Tensile Strength	Weight Per Metre
			P (mm)	d1 max (mm)	b1 min (mm)	d2 max (mm)	L max (mm)	Lc max (mm)	h2 max (mm)	T max (mm)	Q min (kN/LB)	Qo (kN)	q (kg/m)
WN-RC40	08A-1	40	12.700	7.95	7.65	3.98	16.60	17.80	12.07	1.50	14.10/3205	17.9	0.65
WN-RC50IMP	10A-1	50	15.875	10.16	9.40	5.08	20.70	22.20	15.09	2.03	22.20/5045	25.3	1
WN-RC50HIMP	10AH-1	50H	15.875	10.16	9.40	5.08	21.50	24.40	15.09	2.42	22.20/5045	30.2	1.25
WN-RC60IMP	12A-1	60	19.050	11.91	12.57	5.91	25.90	27.70	18.00	2.42	31.80/7227	42	1.53
WN-RC60HIMP	12AH-1	60H	19.050	11.91	12.57	5.94	27.60	31.90	18.00	3.25	31.80/7227	42.7	1.87
WN-RC80IMP	16A-1	80	25.400	15.88	15.75	7.92	33.00	35.00	24.00	3.24	56.70/12886	72.3	2.61
WN-RC80HIMP	16AH-1	80H	25.400	15.88	15.75	7.92	34.50	39.40	24.00	4.00	56.70/12886	71.4	3.1
WN-RC100IMP	20A-1	100	31.750	19.05	18.90	9.53	40.40	44.70	30.10	4.00	88.50/20114	110.5	3.9
WN-RC100HIMP	20AH-1	100H	31.750	19.05	18.90	9.53	42.00	46.90	30.00	4.80	88.50/20114	112.4	4.52

OE manufacturer's names and brands are used for identification purposes only

Products listed are replacement part only - not OEM



To order parts, call James on 0401709850 or email james@metismachinery.com.au